

project name	Expansion of the Parchim Baltic Airport	
	Design for airfield development	
owner	Parchim International Airport, Parchim (Germany)	
airside designer	Consultant Mr Eng Jürgen Schemykal, Stuttgart (Germany)	
location	Parchim (Germany)	
duration	start	spring 2012
	end	2014



aviation + sanitation
featured projects

The Parchim airfield located east of Hamburg and north of Berlin was one of the first airfields in Germany and was used by the Soviet armed forces until the 1990s.

The Chinese investor and owner of the airport develops the now called Baltic Airport to an air cargo airport.

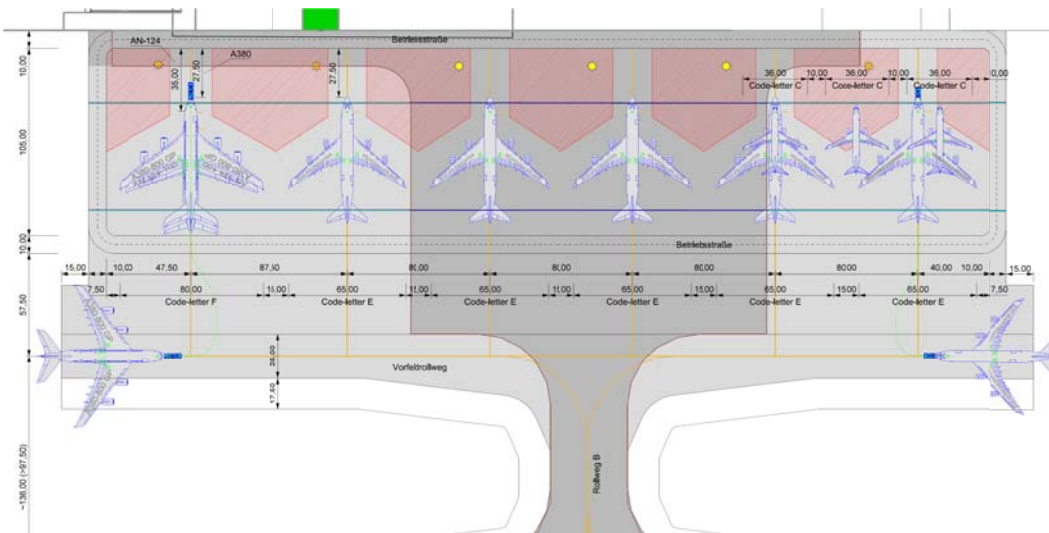

Parchim Baltic Airport platform development

activities

Schematic design, design development, final design, specification writing and construction supervision for airfield development, stormwater conveyance and management systems for an apron area of about 5 hectare (12.5 acre):

- slot drainage gutters
- underground stormwater detention sewers and detention basins
- separation facility for highly contaminated stormwater from aircraft deicing pads and less contaminated stormwater
 - underground mineral fuel separator
 - stormwater pumping stations
 - stormwater sewers up to DN2000 (NPS 80“)
- Wastewater pumping station and transmission pressure main to wastewater treatment plant for high contaminated stormwater from deicing pads



energy + power
water + sanitation
agriculture
industry + production
building services

illustrations

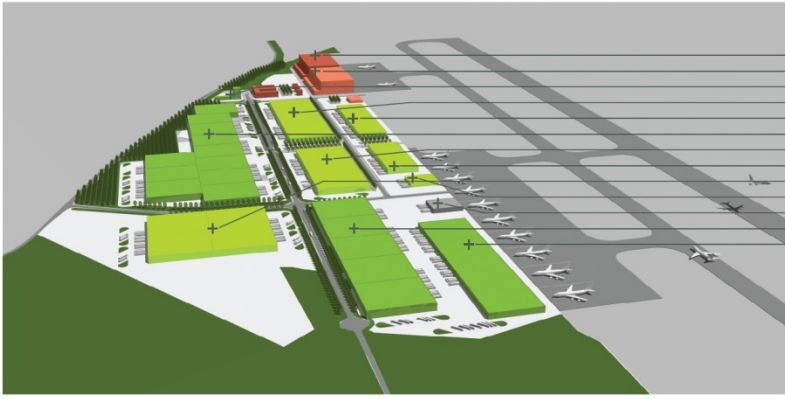

- Hangar 22,000 m²
- Hangar 22,000 m²
- Office space 8,000 m²
- Warehouses and light industrial space 41,500 m²
- Cargo terminal 19,300 m²
- Warehouses and light industrial space 114,000 m²
- Warehouses and light industrial space 31,100 m²
- Cargo terminal 13,100 m²
- Warehouses and light industrial space 41,500 m²
- Cargo terminal 3,000 m²
- Warehouses and light industrial space 3,000 m²
- Cargo terminal 52,000 m²
- Cargo terminal 34,000 m²

Parchim Airport City Plan ©www.parchim-airport.com



aviation + sanitation
featured projects



energy + power
water + sanitation
agriculture
industry + production
building services